

D1 ANALOG

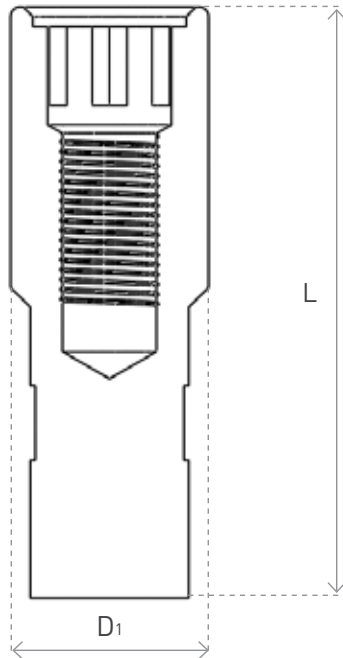

D1-3.75 Implant Analog	D1-5 Implant Analog	D1-6 Implant Analog
D1-3.75	D1-5	D1-6
D_1 (mm) = 4 L (mm) = 12	D_1 (mm) = 5 L (mm) = 12.3	D_1 (mm) = 6 L (mm) = 12.3

